

FESTIVAL INTERNACIONAL DE XARDÍNS DE ALLARIZ 2025

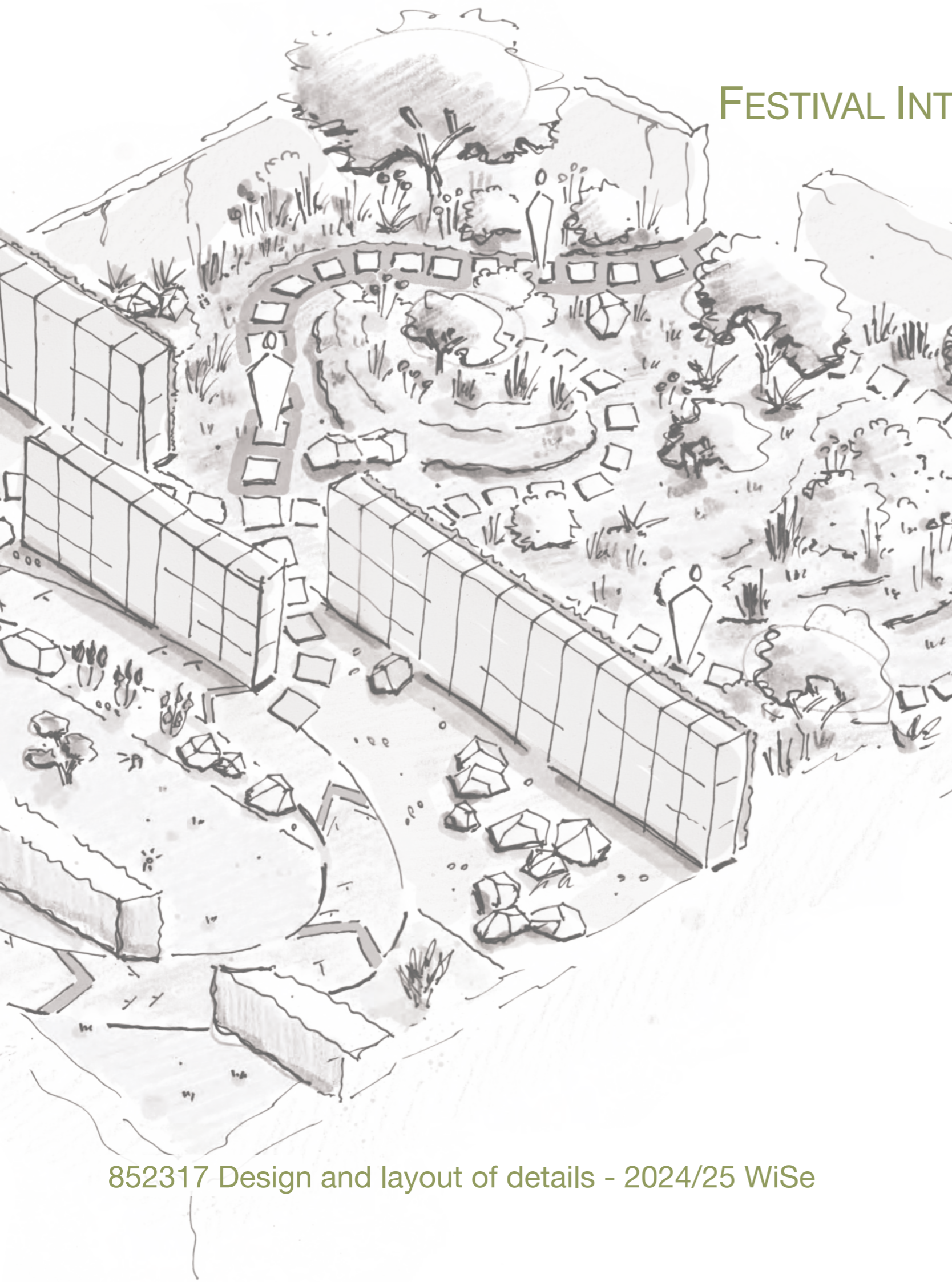

Y O U R
G A R D E N
Y O U R
C H O I C E

CONTENTS

	01 INTRODUCTION	
	01.01 IDEA AND CONCEPT	2
	01.02 PRESENTATION PLAN	3
	02 CONSTRUCTION	
	02.01 SECTIONAL VIEWS	4
	02.02 CONSTRUCTION PLAN	5
	03 TECHNICAL DETAILS	
	03.01 PAVING PLAN	6
	03.02 REGULAR DETAILS	7
	03.03 GABIONS CONSTRUCTION	8
	03.04 IRRIGATION	9
	04 PLANTING	
04.01	TREES AND HEDGES PLANTING PLAN	10
04.02	PERENNIAL PLANTING PLAN	11
04.03	GABIONS PLANTING PLAN	12
	04.04 PLANTING SHOWCASE	12
04.05	FLOWERING CALENDAR	13
	05 CALCULATION	
05.01	COSTS OF VEGETATION	14
05.02	COSTS OF MATERIAL	15

01 INTRODUCTION

01.01 IDEA AND CONCEPT

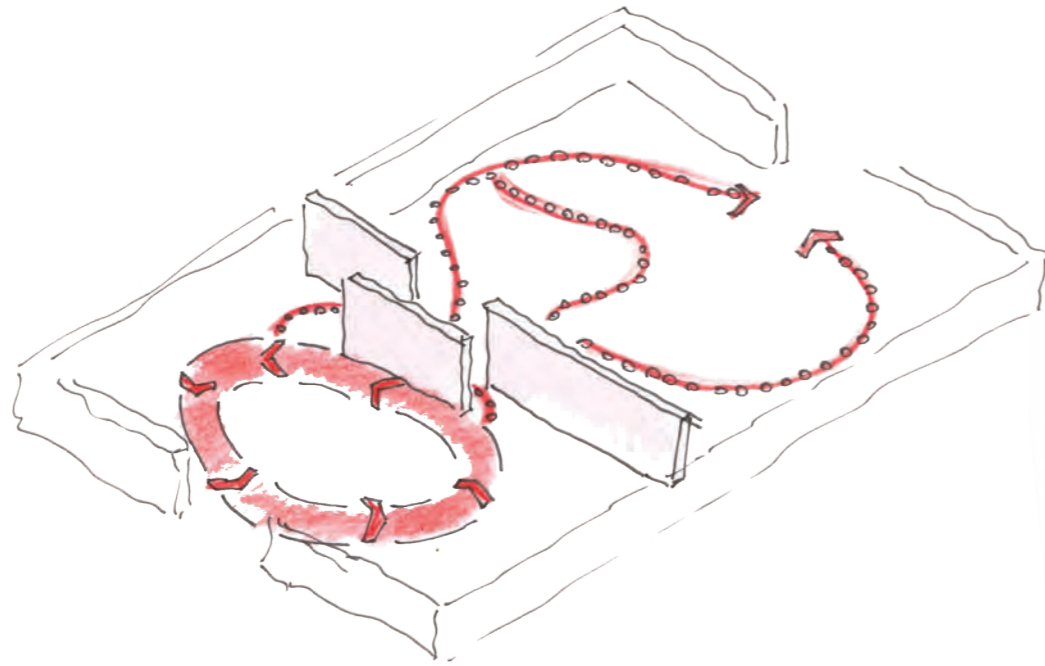

The last habitat for insects has been moved away, too many stones radiate heat and we do this to ourselves every year? The contrast between a heavily sealed, over-maintained garden design and a nature oriented one is the main topic of this garden project. The choice is yours, how do you decide?

Many gardens of contemporary garden design are already characterized by sealed surfaces, gravel landscapes, monotonous plant selection and overly watered and mowed lawns. We would like to show the potential of such areas: Unsealed surfaces, a varied selection of plants, exciting paths and natural shading by trees can increase the well-being of garden spaces.



A contemporary garden layout can be seen at the front of the show garden. The paths symbolize a cycle: We move in circles, escaping seems difficult. Do we have to stay in this hot, unattractive garden forever? No! We just have to look around the corner and explore new paths! Two exits lead to the second part, the climate-friendly garden.

01.02 PRESENTATION PLAN

Gabion walls in the middle of the garden create a boundary between the different spaces. A difference in microclimate is noticeable, the barrier makes it clear - it won't be an easy path.

The gabion walls are filled with stones on one side and planted on the other; the same concrete slabs are used on both sides. The same materials make it clear: Everyone has the opportunity to use the same means to make a difference to the design and do something for the well-being of their own and nature.

The choice is yours! It's time to make the right choice!

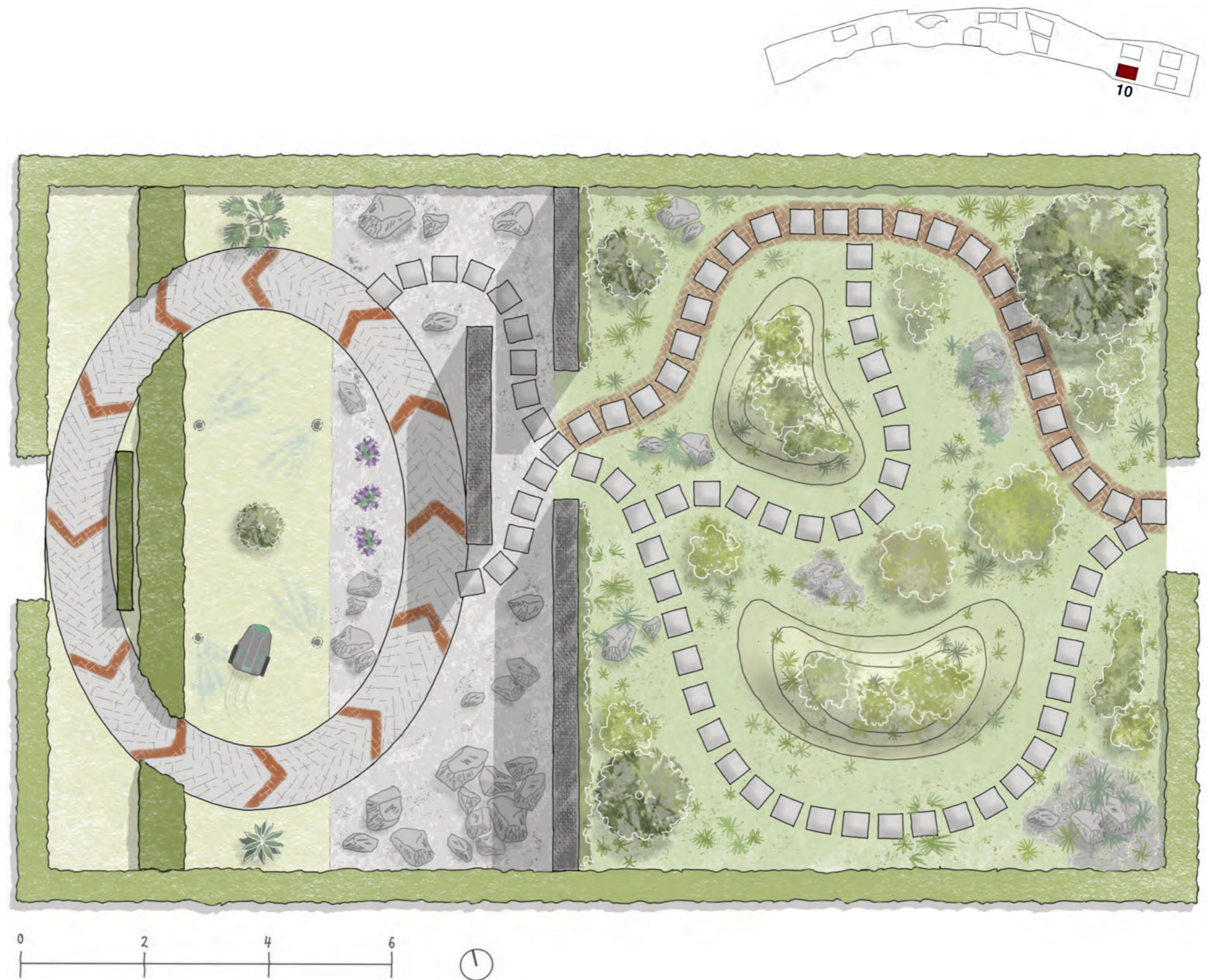

02 CONSTRUCTION



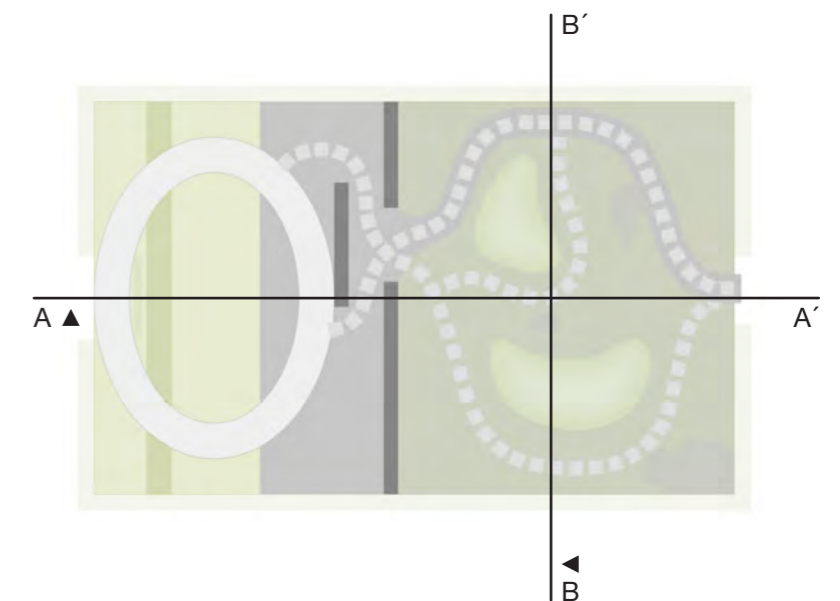
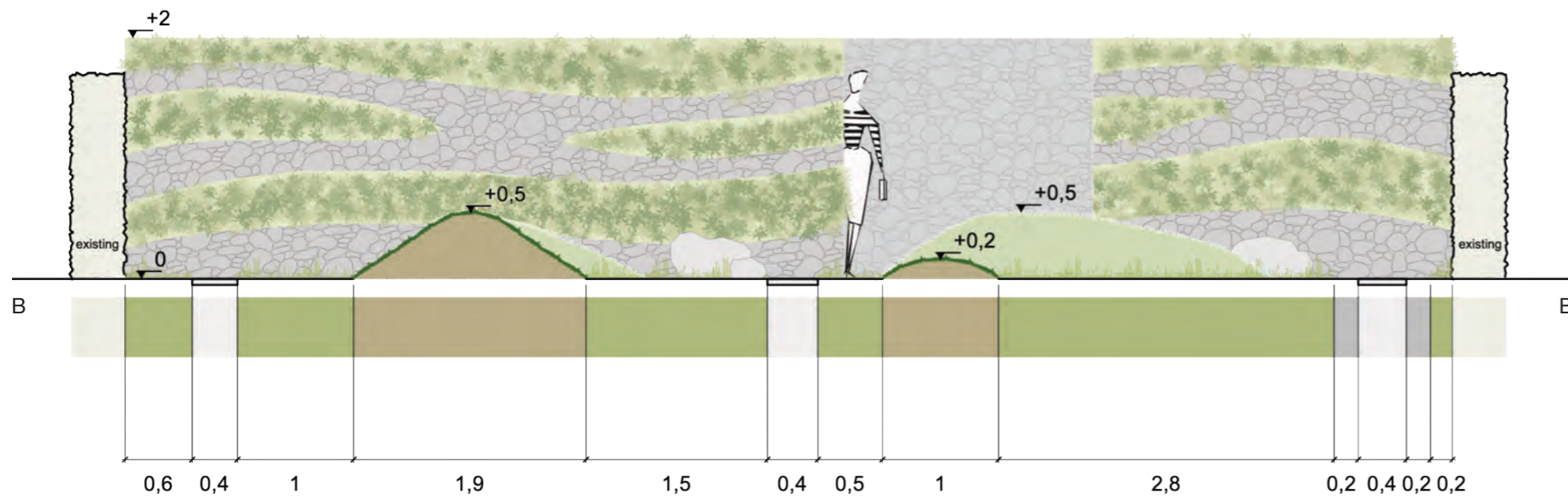
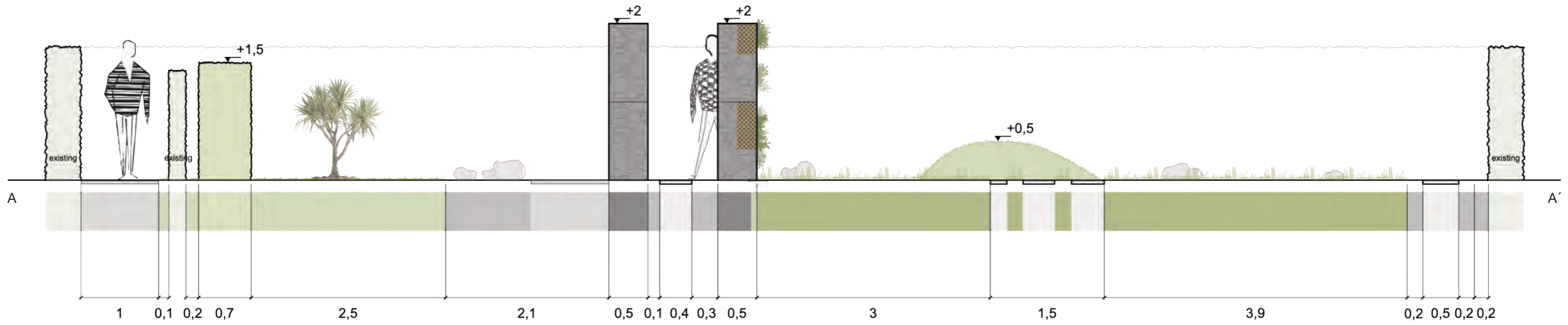



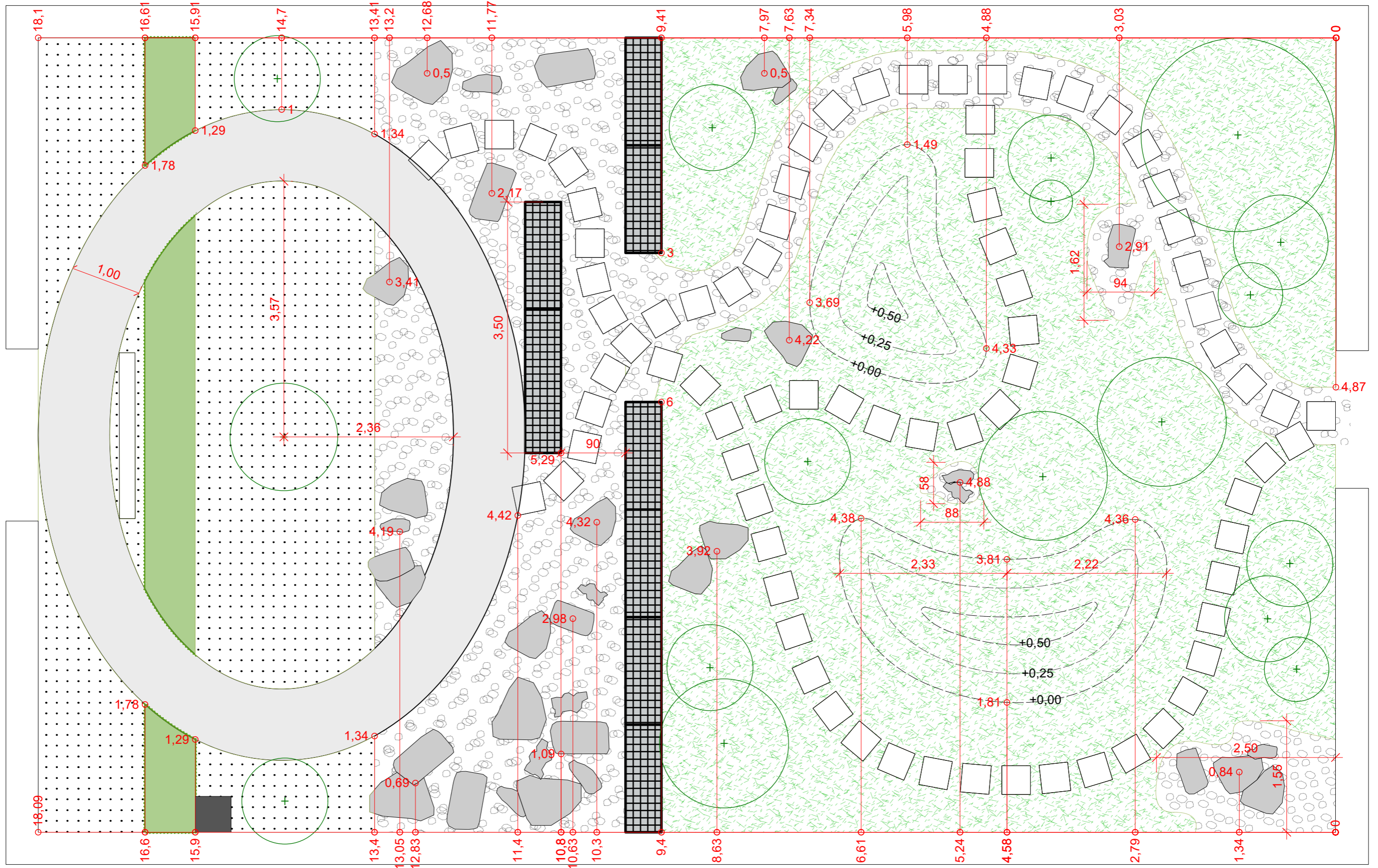

02.01 SECTIONAL VIEWS

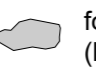

02.02 CONSTRUCTION PLAN

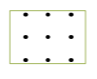
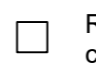
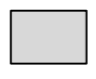





LEGEND Scale 1:50 [m]

-  tree replanting
-  hedge
-  foundlings (laid freely)
-  details gabions
-  RD 1 gravel
-  RD 2 rolled turf
-  RD 3 concrete slab
-  RD 4 / detail paving sett
-  RD 5 landscape rolled turf
-  automower
- 

03 TECHNICAL DETAILS

03.01 PAVING PLAN

LEGEND

-  steel strip
-  strip foundation
-  paving sett black 20x10x5 cm
-  paving sett gray 20x10x5 cm

gray concrete paving sett
20x10x5 cm with black
arrows, skid resistant, bevel

paving sett grouted with
sand 0/2 mm

installation according to rule
detail RD 4

Section as a template for
the remaining quarter
circles

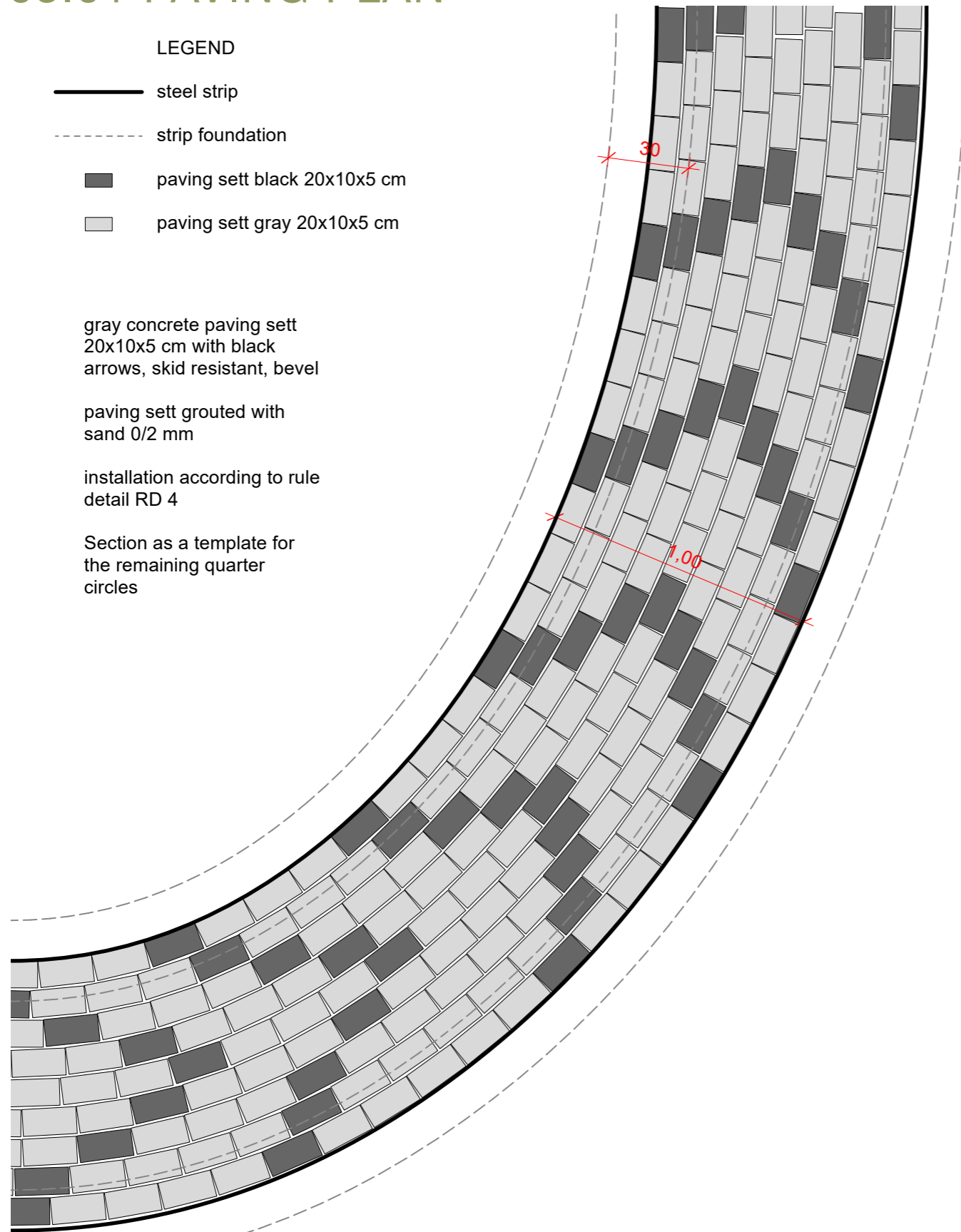

arrangement of arrow shapes Scale 1:20 

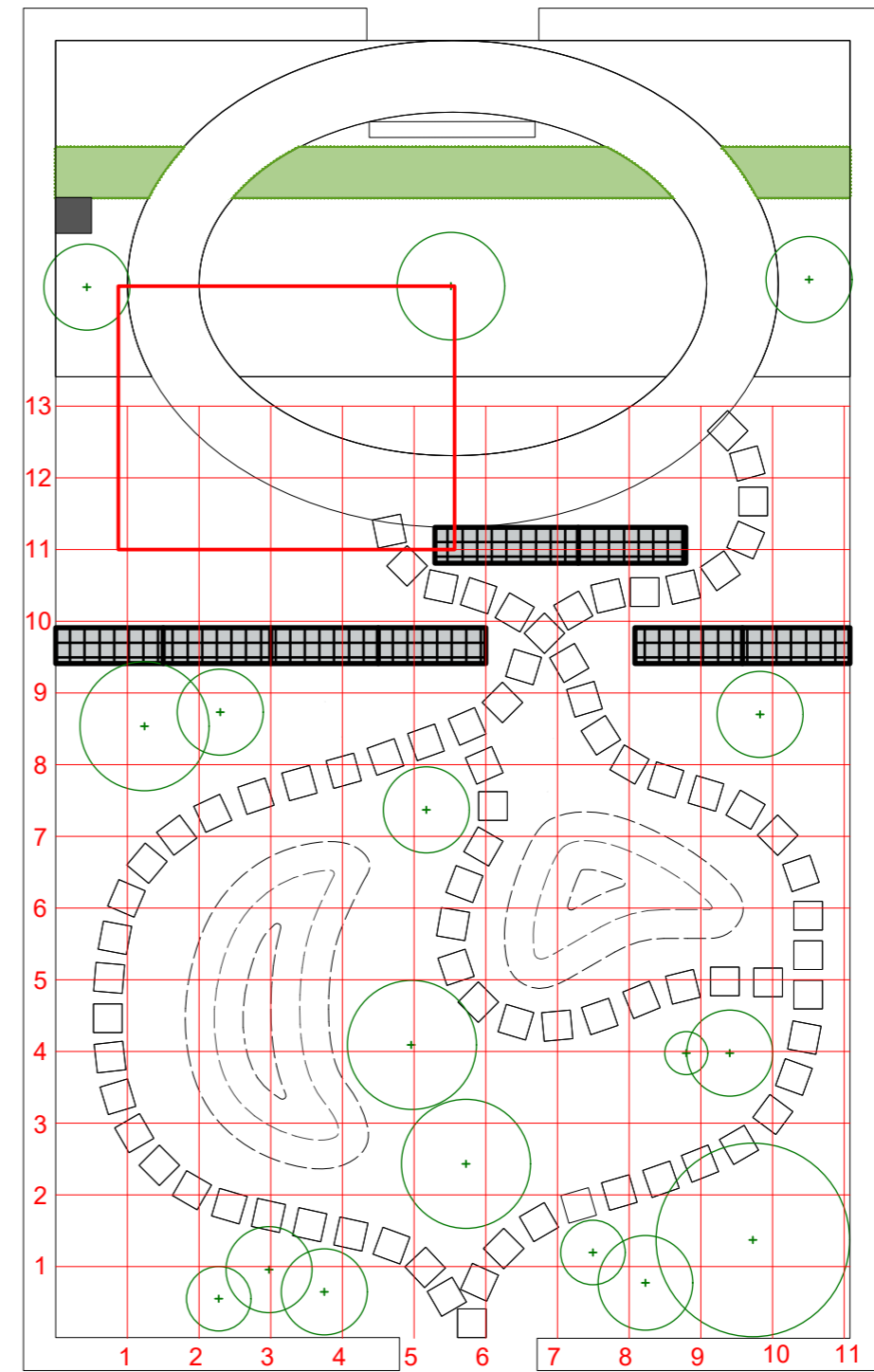

arrangement of concrete slabs Scale 1:100 [m] 

03.02 REGULAR DETAILS

RD 1 - gravel

installation height: 10 cm

- 10 cm Gravel 16/32 mm colour: grey
- geotextile filter fleece 150g
- undisturbed soil

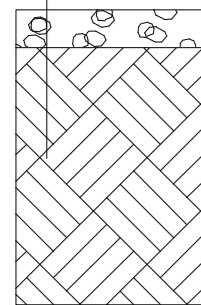

RD 2 - rolled turf

installation height: 12,5 cm

- rolled turf
- 1,5 cm rolled turf substrate
- 1 cm sand
- 10 cm substrate
- undisturbed soil

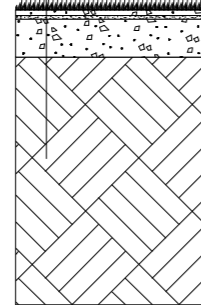

RD 3 - concrete slab

installation height: 25 cm

- 5 cm concrete slab 40x40x5 cm; colour: gray/ black; skid resistant, bevel
- 2 cm bedding 0/2 mm
- 15 cm gravel base layer 0/32 mm; RStO12 Bk0,3
- undisturbed soil

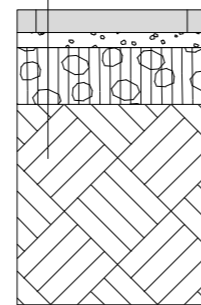

RD 4 - paving sett detail (page 6)

installation height: 24 cm

- 5 cm concrete paving sett 20x10x5 cm; colour: gray/black; skid resistant, bevel, sand 0/2 mm grouted
- 2 cm bedding sand 0/2 mm
- 15 cm gravel base layer 0/32 mm; RStO12 Bk0,3
- undisturbed soil

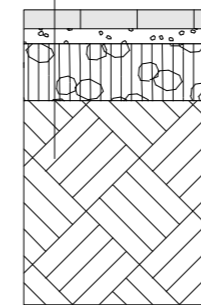

RD 5/6 - landscape rolled turf (RD 5) and mound (RD 6)

installation height: 42,5 - 92,5 cm

- landscape rolled turf with herbs; cutouts for herbaceous perennials
- 1,5 cm rolled turf substrate
- 1 cm sand
- 40 cm substrate
- 0-50cm excavation material refilled
- undisturbed soil

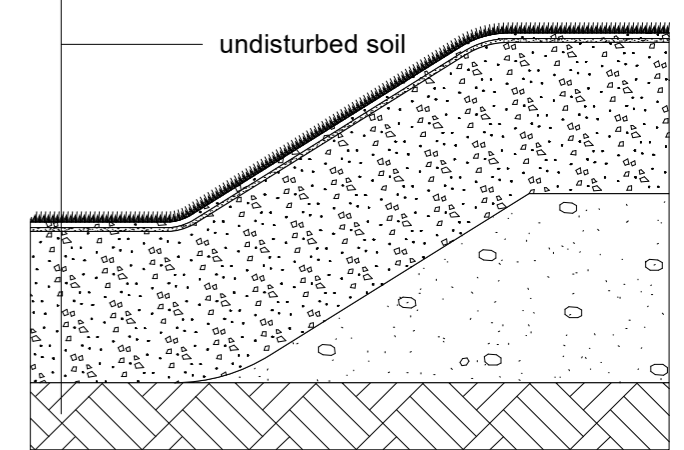

Connections

Con 1 - RD 1 to RD 4

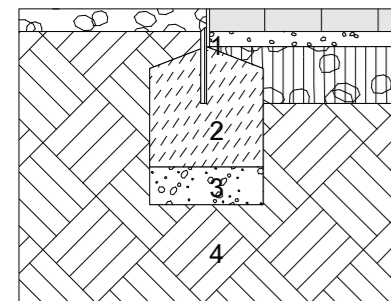

- 1 steel strip 3-5 mm, with ground anchor concrete C12/15
- 2 frost protection layer 0/32 mm
- 3 substructure or undisturbed soil as base
- 4

Con 2 - RD 2 to RD 1

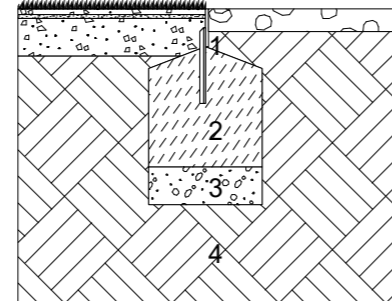

- 1 steel strip 3-5 mm, with ground anchor concrete C12/15
- 2 frost protection layer 0/32 mm
- 3 substructure or undisturbed soil as base
- 4

Con 3 - RD 2 to RD 4

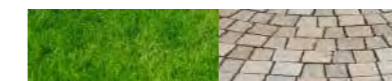
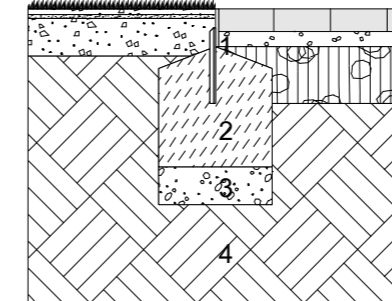

- 1 steel strip 3-5 mm, with ground anchor concrete C12/15
- 2 frost protection layer 0/32 mm
- 3 substructure or undisturbed soil as base
- 4

Con 4 - RD 5 to RD 3 to RD 1

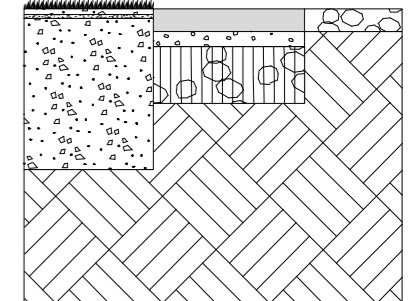

Scale 1:20

03.03 GABIONS CONSTRUCTION

cross section 1

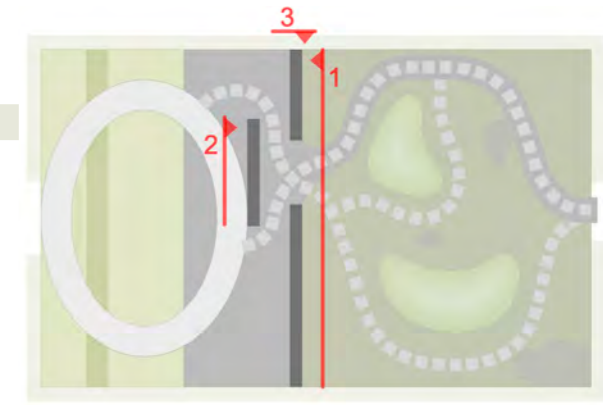
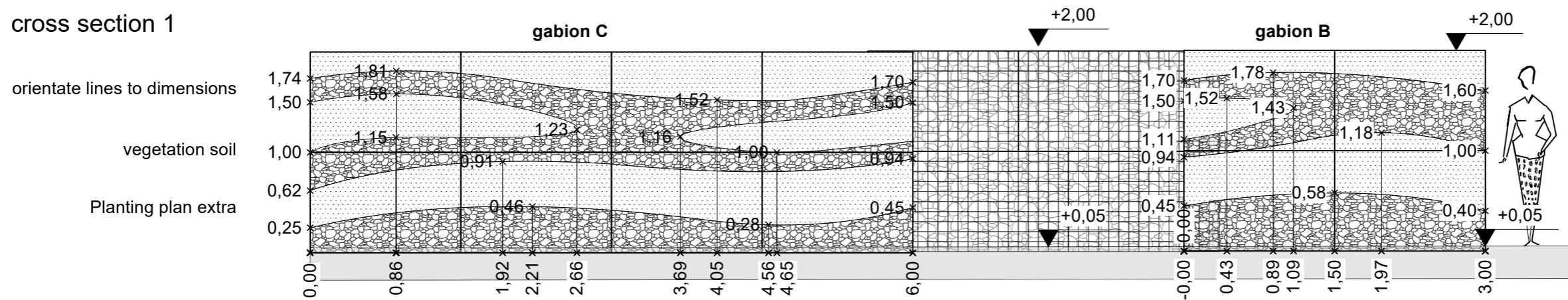

cross section 2

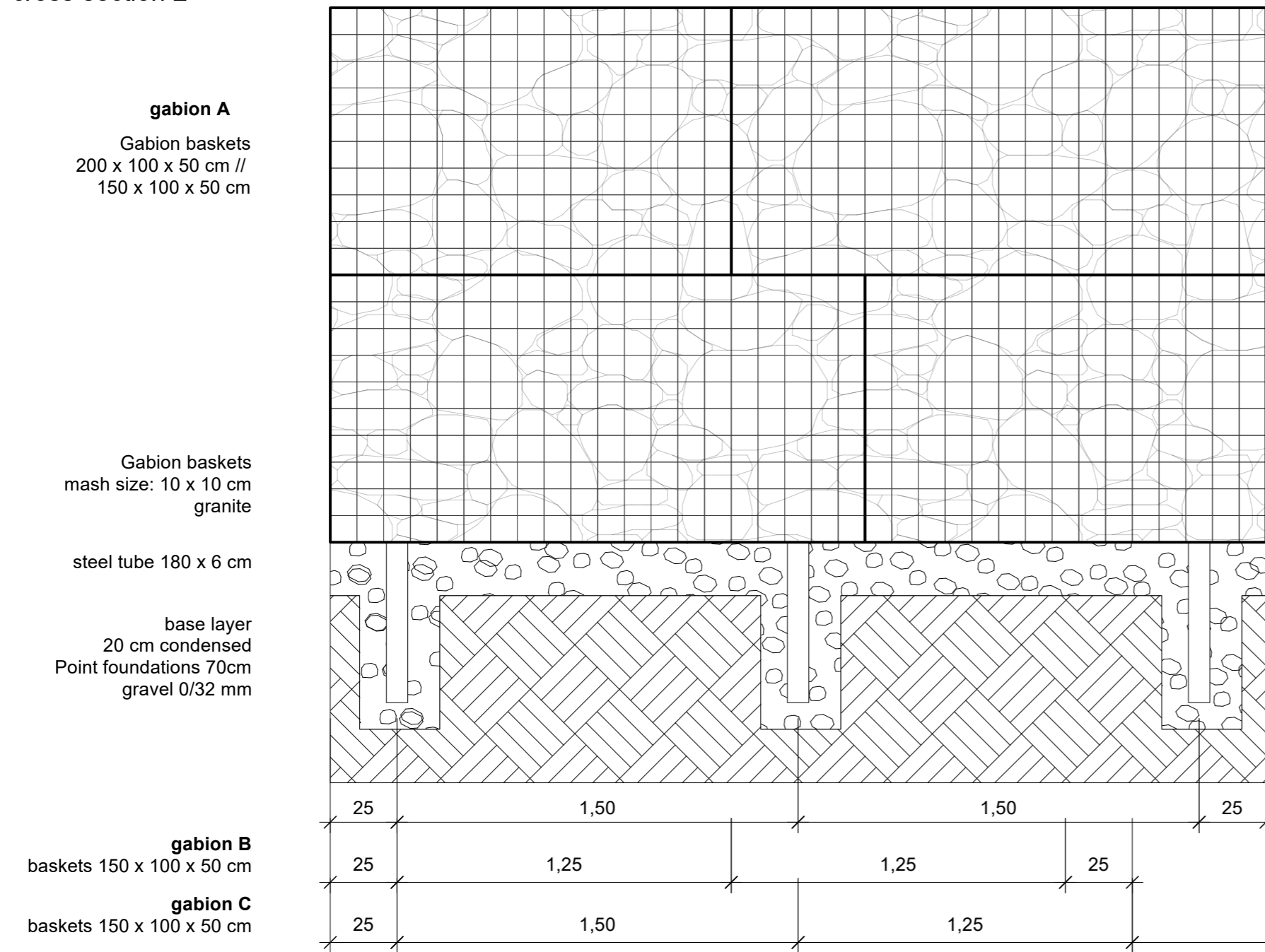

cross section 3

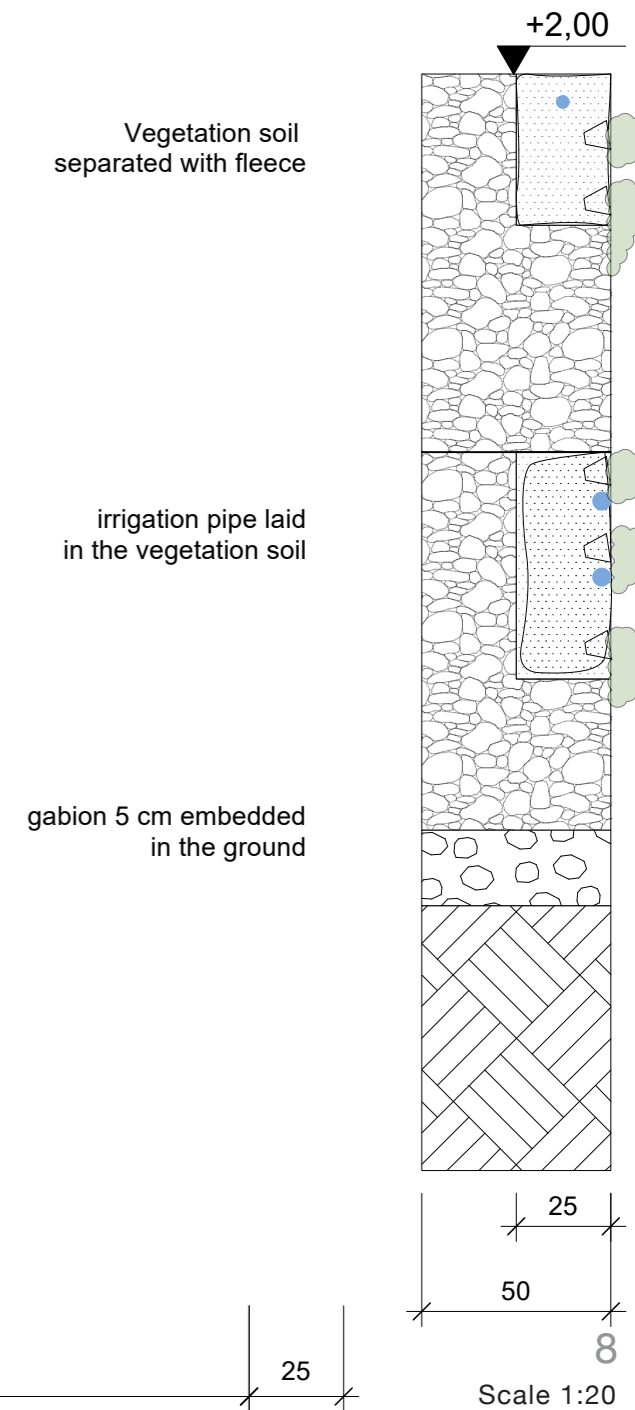

03.04 IRRIGATION

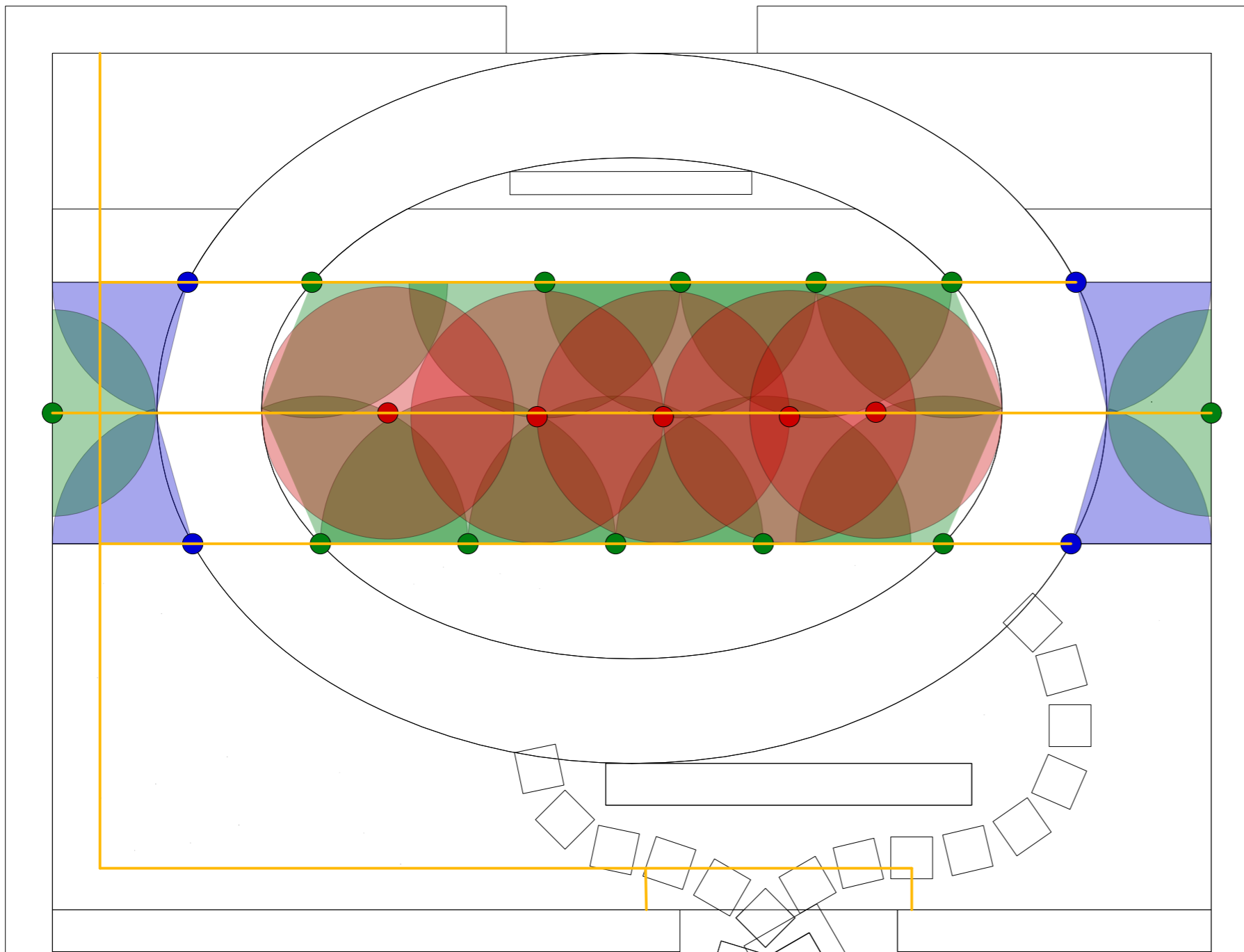

LEGEND

-  Rainbird 6-VAN- Serie 90°, 1,5 bar
-  Rainbird 6-VAN- Serie 90°, 1,5 bar
-  Rainbird 6-VAN- Serie 360°, 1,5 bar
-  Supply line DN 32



Rainbird 6-Van-Serie



supply line



automower Husqvarna



spacer distance 10 cm 



irrigation drip line 

Scale 1:50 [m] 

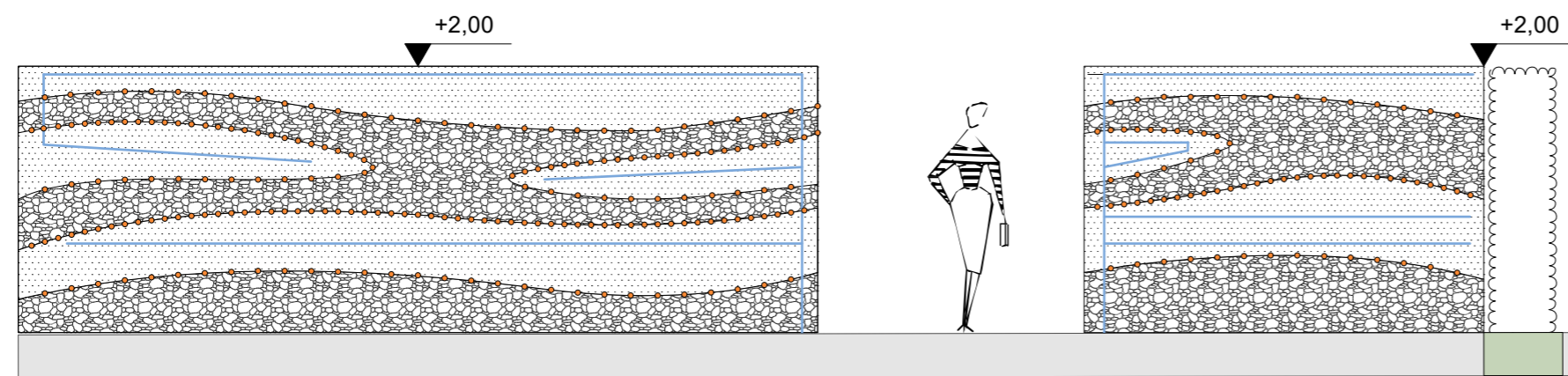

04 PLANTING

04.01 TREES AND HEDGES PLANTING PLAN

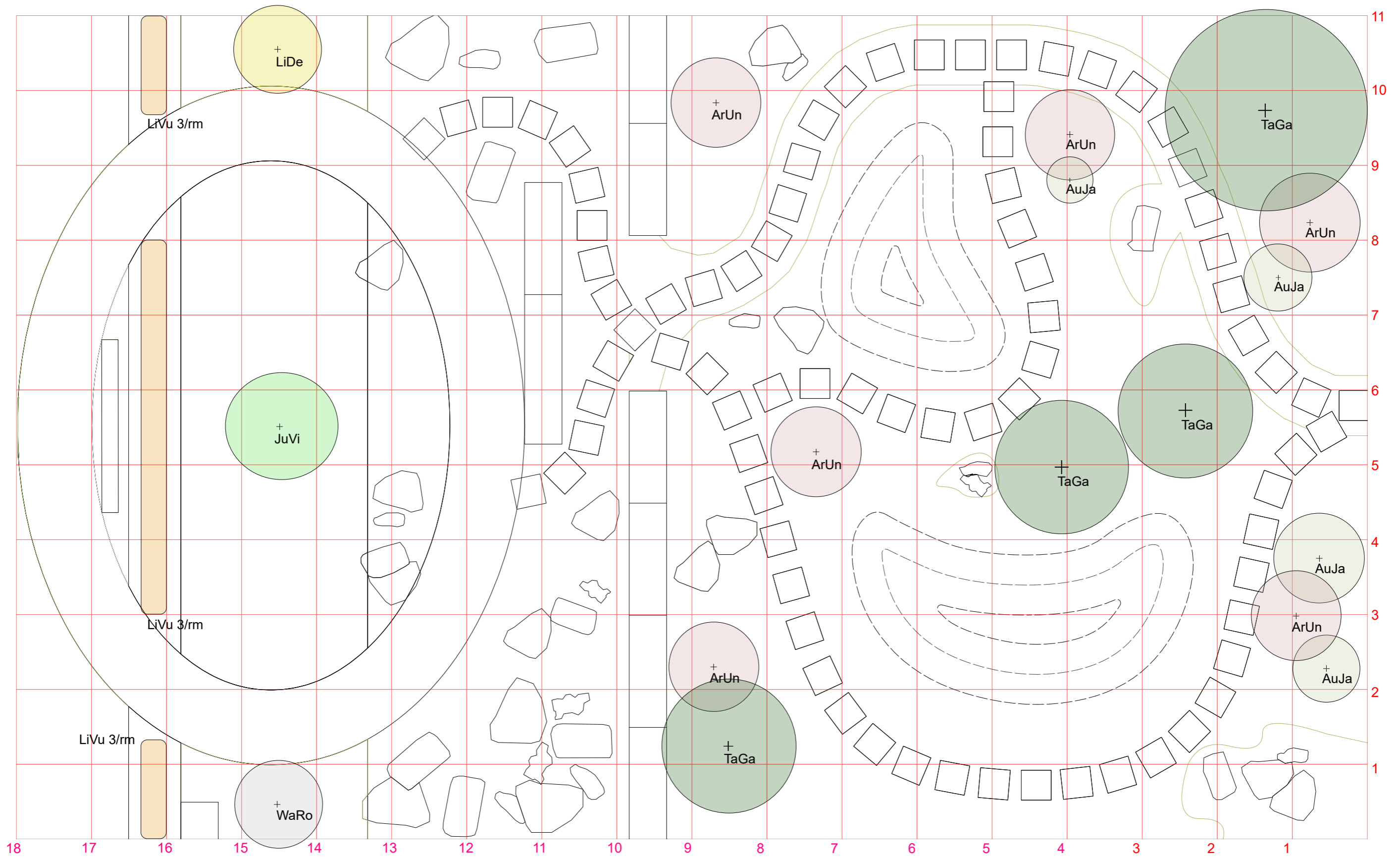



Scale 1:50 [m] 

LEGEND

 LiVu – Ligustrum vulgare – 23 pcs

 JuVi – Juniperus virginiana – 1 pcs

 WaRo – Washingtonia robusta – 1 pcs

 LiDe – Ligustrum delavayanum – 1 pcs

 TaGa – Tamarix galicia – 4 pcs









 ArUn – Arbutus unedo – 6 pcs

 AuJa – Aucuba japonica – 4 pcs

04.02 PERENNIAL PLANTING PLAN

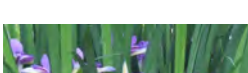

LEGEND

-  FoVu Foeniculum vulgare – 38 pcs
-  TeFr Teucrium fruticans – 35 pcs
-  PiTo Pittospatum tobira – 54 pcs
-  AgAf Agapanthus africanus – 39 pcs
-  PaOr Papaver orientale – 35 pcs
-  ErCa Erica carnea – 16 pcs
-  StBy Stachys byzantina – 71 pcs
-  IrGr Iris graminea – 64 pcs
-  AlSp Allium sphaerocephalon – 68 pcs
-  ThSe Thymus serpyllum – 246 pcs

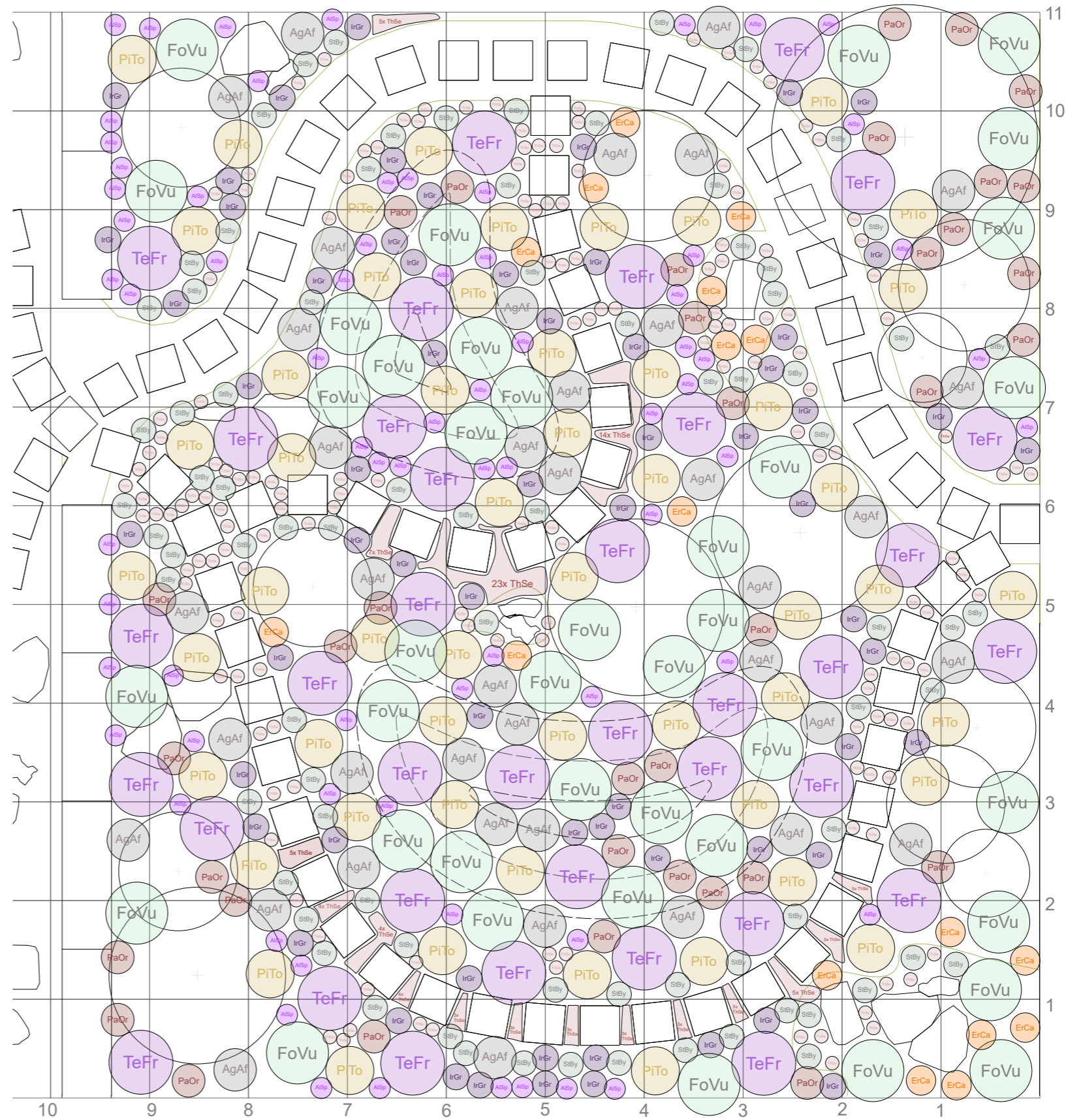





Scale 1:50 [m]



04.03 GABIONS PLANTING PLAN

LEGEND

-  ThSeA Thymus serpyllum "Album" – 103 pcs
-  SaNe Salvia nemorosa – 35 pcs
-  DiPy Dianthus pyrenaicus – 39 pcs
-  NeFa Nepeta x faassenii – 34 pcs

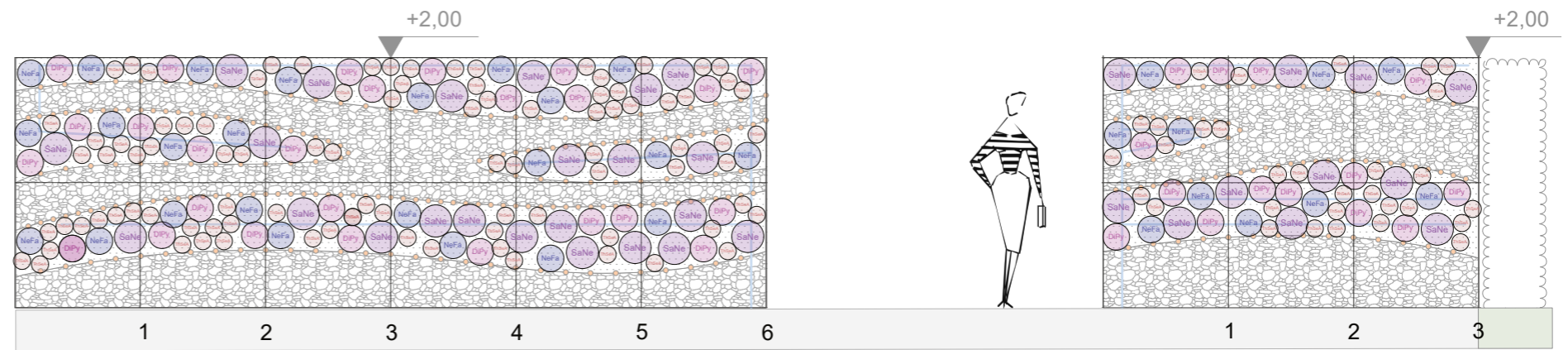

Scale 1:50 [m]

04.04 PLANTING SHOWCASE

Frontyard

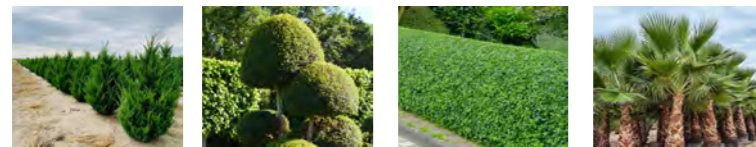

JuVi LiDe LiVu WaRo

Gabions

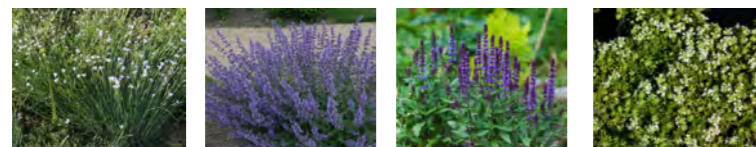

DiPy NePa SaNe ThSeA

Backyard

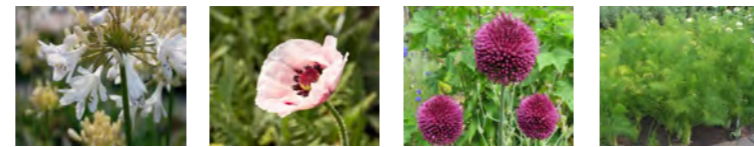

AgAf PaOr AlSp FoVu

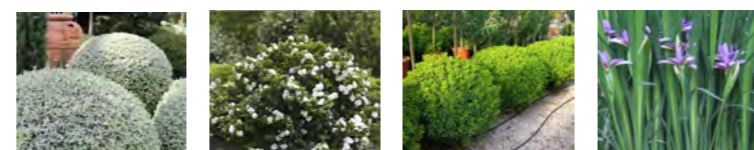

TeFr GaJa PiTo IrGr

Stonegarden



StBy ThSe ErCa

Trees



ArUn AuJa TaGA

04.05 FLOWERING CALENDAR

	Jan.	February	March	April	May	June	July	Aug.	Sep.	Nov.	Dec.
Front-yard											
JuVi											
LiDe											
LiVu											
WaRo											
Back-yard											
AgAf											
AlSp											
FoVu											
IrGr											
PaOr											
PiTo											
StBy											
TeFr											
Stonegarden											
ErCa											
StBy											
ThSe											
Gabions											
DiPy											
NeFa											
SaNe											
ThSeA											
Trees											
AuJa											
TaGa											



05 CALCULATION

05.01 COSTS OF VEGETATION

Symbol	botanical name	sort	hight (cm)	light	plants / m²	quality	quantity	price per plant	total price	source
Front-yard										
JuVi	Juniperus virginiana	Canaertii	225	sun	1	Str.mB/Co	1	326,00 €	326,00 €	https://www.praskac.at/virginischer-baumwacholder/juniperus-virginiana-canaertii
LiDe	Ligustrum delavayanum		150	sun	1	50l	1	169,00 €	169,00 €	https://olivenbaum.de/liguster/558/ligustrum-delavayanum
LiVu	Ligustrum vulgare	Atrovirens	80	sun	3/lfm	C5	23	8,99 €	206,77 €	https://www.praskac.at/aufrechter-liguster/ligustrum-vulgare-atrovirens
WaRo	Washingtonia robusta		120	sun	1	P26	1	32,95 €	32,95 €	https://www.mypalmshop.de/washingtonia-robusta-multistamm
Back-yard										
AgAf	Agapanthus africanus	Arctic star	70	sun	4	P1	39	8,99 €	350,61 €	https://shop.starkl.at/schmucklilie-arctic-star
AlSp	Allium sphaerocephalon		80	sun	10	P9	68	4,99 €	339,32 €	https://www.praskac.at/kugelkoeffiger-lauch/allium-sphaerocephalon
FoVu	Foeniculum vulgare		120	sun	4	P9	38	4,99 €	189,32 €	https://www.praskac.at/fenchel/foeniculum-vulgare
IrGr	Iris Graminea		30	sun	10	P9	64	5,00 €	320,00 €	https://www.die-staudengaertneri.de/iris-graminea
PaOr	Papaver orientale		60	sun	2	P9	35	1,80 €	63,00 €	https://heckenpflanzen-heijnen.at/orientalischer-mohn-papaver-orientale-brilliant
PiTo	Pittosporum tobira		70	sun	1	C5	54	44,95 €	2.427,30 €	https://www.flora-toskana.com/de/typisch-mediterrane-pflanzen/493-pittosporum-tobira
StBy	Stachys byzantina	Silberteppich	15	sun	10	P9	71	4,99 €	354,29 €	https://www.praskac.at/wollziest-lammohr/stachys-byzantina-silberteppich
TeFr	Teucrium fruticans		100	sun	12	C3	35	4,50 €	157,50 €	https://www.germigarden.com/es/arbustiva/550020338-teucrium-fruticans.html
Stonegarden										
ErCa	Erica carnea		40	sun	5	P9	16	4,95 €	79,20 €	https://www.pflanzmich.de/produkt/17110/schneeheide-winter-beauty.html
StBy	Stachys byzantina	Silberteppich	15	sun	10	P9	71	4,99 €	354,29 €	https://www.praskac.at/wollziest-lammohr/stachys-byzantina-silberteppich
ThSe	Thymus serpyllum		10	sun	10	na	246	2,17 €	533,82 €	https://www.heckenpflanzendirekt.at/thymus-officinalis.html
Gabions										
DiPy	Dianthus pyrenaicus		20	sun	15	P9	39	3,90 €	152,10 €	https://wildblumenliebe.de/shop/dianthus-pyrenaicus-pyrenaeen-nelke
NeFa	Nepeta x faassenii		30	sun	3	P9	34	4,00 €	136,00 €	https://www.baumschule-horstmann.de/shop/exec/product/698/3068/Blaue-
SaNe	Salvia nemorosa		30	sun	4	na	35	5,00 €	175,00 €	https://shop.wildeblumen.at/pflanzen/169/salvia-nemorosa-steppen-salbei
ThSeA	Thymus Serpyllum	Album	30	sun	15	P9	103	4,20 €	432,60 €	https://www.sarastro-stauden.com/shop/pflanzen-fuer-steingarten-und-alpinum/thymus-
Trees										
AuJa	Aucuba japonica		100	shadow	1	Str.mB/Co	4	34,99 €	139,96 €	https://www.praskac.at/buntblaettrige-aukuba/aucuba-japonica-variegata
TaGa	Tamarix galacia		200	sun	na	C30	4	147,90 €	591,60 €	https://www.baumschule-newgarden.de/3868/franzoesische-tamariske/tamarix-gallica
Total plants		982								
Total price		7.530,63 €								

05.02 COSTS OF MATERIAL

material	Amount	Unit	Price per unit	Final price	Notice	source
Paved areas						
Gravel 16/32 mm Granite	3,3	m³	144,00 €	472,18 €	90€ net price/to, 1,6to/ m³	https://menz-gmbh.de/produkte/granit-splitt-hellgrau-16-32-mm-lose-4715/
Vlies	32,8	m²	1,16 €	38,04 €	net price	https://www.rosa-moser.at/produkte/geotextil-filtervlies-t150%2C-2m-breit%2C-50lfm
Gravel 0/32 mm	11,7	m³	39,49 €	461,78 €	net price	PDF Preisliste Schulte
Sand 0/2 mm	0,8	m³	42,00 €	35,53 €	28€ net price/to, 1,5to/ m³	https://menz-gmbh.de/produkte/sand-0-2-mm-grau-doppelt-gewaschen-0152/
Concrete slabs 40x40x5 cm	160,0	piece	4,52 €	723,20 €	18,26€/m²	PDF Preisliste Schulte
paving 20x10x5 cm	16,7	m²	14,18 €	236,71 €	0,35€/piece Brutto, 50 Pices/m²	PDF Preisliste Schulte
paving 20x10x5 cm grey	5,1	m²	14,18 €	72,31 €	0,35€/piece Brutto, 50 Pices/m²	PDF Preisliste Schulte
steel strip	52,5	m	17,69 €	929,24 €	43,67€/2m Brutto	https://shop.gartenmetall.de/wegbegrenzungsband-eco-liner/parent-eco-liner
Concrete C12/15	4,4	m³	128,07 €	565,22 €	net price	PDF Preisliste Schulte
Gabion 200x100x50 cm						
Basket type A	1,0	pcs	87,77 €	87,77 €	net price, bottom left	https://www.gabionenshop.com/gabionen-korb.html
Basket type D	1,0	pcs	64,66 €	64,66 €	net price, top right	https://www.gabionenshop.com/gabionen-korb.html
Gabion 150x100x50 cm						
Basket type A	2,0	pcs	73,53 €	147,06 €	net price, bottom left	https://www.gabionenshop.com/gabionen-korb.html
Basket type B	5,0	pcs	64,88 €	324,41 €	net price, bottom right	https://www.gabionenshop.com/gabionen-korb.html
Basket type C	3,0	pcs	61,09 €	183,27 €	net price, top left	https://www.gabionenshop.com/gabionen-korb.html
Basket type D	4,0	pcs	53,14 €	212,58 €	net price, top right	https://www.gabionenshop.com/gabionen-korb.html
Gabion stones	10,2	m³	424,67 €	4.322,05 €	net price	https://www.kiesdirekt.de/p/granit-schroppen-grau-80-150-mm-1673.asp#
foundlings	38,0	to	79,38 €	3.016,44 €	net price, 350kg/ stone	https://menz-gmbh.de/produkte/granit-findling-nordisch-bunt-ab-50-cm-naturgerundet-deutschland-0210/
Substrate	2,3	m³	37,05 €	86,05 €	net price	PDF Preisliste Schulte
Vlies	35,8	m²	1,16 €	41,54 €	net price	https://www.rosa-moser.at/produkte/geotextil-filtervlies-t150%2C-2m-breit%2C-50lfm
Spacer	266,0	pcs	0,49 €	129,28 €	net price	https://www.gabionenshop.com/verbindungstechnik.html
steel tube 180 x 6 cm	11,0	pcs	68,70 €	755,75 €	net price	https://www.gabionenshop.com/verbindungstechnik.html
Vegetation						
Sand 0/2 mm	1,1	m³	39,49 €	44,53 €	28€ net price/to, 1,5to/ m³	https://menz-gmbh.de/produkte/sand-0-2-mm-grau-doppelt-gewaschen-0152/
Substrate	37,9	m³	37,05 €	1.403,57 €	net price	PDF Preisliste Schulte
rolled turf substrate	1,7	m³	299,70 €	506,91 €	net price	https://www.bau-und-gartenshop.de/p/rasenerde-spezialsubstrat-fuer-rollrasen-0-5-mm-big-bag-1000-l
rolled turf	31,9	m²	5,55 €	176,83 €	net price	https://www.schwab-rollrasen.de/online-shop/rollrasen/spiel-und-gebrauchsrasen
landscape rolled turf	80,9	m²	5,14 €	416,06 €	net price	https://www.schwab-rollrasen.de/online-shop/rollrasen/landschaftsrasen-mit-kraeuter
Irrigation						
Irrigation pipe	99,6	m	1,45 €	144,40 €	144,99€/ 100m Brutto	https://www.wasserundgruen.de/PE-Rohr-32-mm---10-bar--PE80---PE100--SDR-17---SDR-17-6--Schwarz--10
drip line	29,2	m	1,00 €	29,15 €	30,99€/25m Brutto	https://www.wasserundgruen.de/Tropfrohr-25-m-Dripline-XFD-Rain-Bird-XFD2333-2-3l-h-Tropferabstand-33c
Rainbird 6VAN serie 90°	4,0	pcs	9,10 €	36,42 €	net price	https://www.wasserundgruen.de/1804-SAM--1806-SAM--1812-SAM-Sprueher-Rain-Bird-mit-Auslaufsperrvent
Rainbird 6VAN serie 180°	12,0	pcs	9,10 €	109,25 €	net price	https://www.wasserundgruen.de/1804-SAM--1806-SAM--1812-SAM-Sprueher-Rain-Bird-mit-Auslaufsperrvent
Rainbird 6VAN serie 360°	5,0	pcs	9,10 €	45,52 €	net price	https://www.wasserundgruen.de/1804-SAM--1806-SAM--1812-SAM-Sprueher-Rain-Bird-mit-Auslaufsperrvent
equipment						
automower Husqvarna Aspire R4	1,0	pcs	849,69 €	849,69 €	net price	https://www.husqvarna.com/at/maehroboter/automower-aspire-r4-inkl-installations-kit/
Plants, calculated on page 14				7.530,63 €		
Total price	24.197,99 €					

FESTIVAL INTERNACIONAL DE XARDÍNS DE ALLARIZ 2025

BOKU // University of Natural Resources and Life Sciences, Vienna, Austria

ILA // Institute of Landscape Architecture

Design and layout of details, WiSe 2024/25

Lecture: DI Roland Wück // Tutor: Ines Altrichter B.Sc.

Students: Elisabeth Kortmann B.Eng., Masha Rusack B.Sc., Niclas Schneider B.Eng.,
Leonard Schwieger B.Sc.

