



FLOWERING DREAMS FOR EVERYONE

852342 PLANTING DESIGN AND HORTICULTURAL ECOSYSTEM MANAGEMENT
WS2024/25

FABER Leopoldine, MACH Lena, STEIGER Simona, TITZ Isabella

Prof. Dipl. Ing. Dr. KRIECHBAUM Monika
Prof. Dipl. Ing. Dr. PLENK Sabine

PROJECT AREA

- 23RD DISTRICT OF VIENNA
- COURTYARD 170 M²
- SUN EXPOSURE: FULL SUN

PICTURE: STEIGER, S.

PLAN

- PRESERVE EXISTING PLANTINGS
- GREEN SEATING AREA
- TREE TO PROVIDE SHADE
- PLAYING AREA
- ADDING FLOWER BEDS



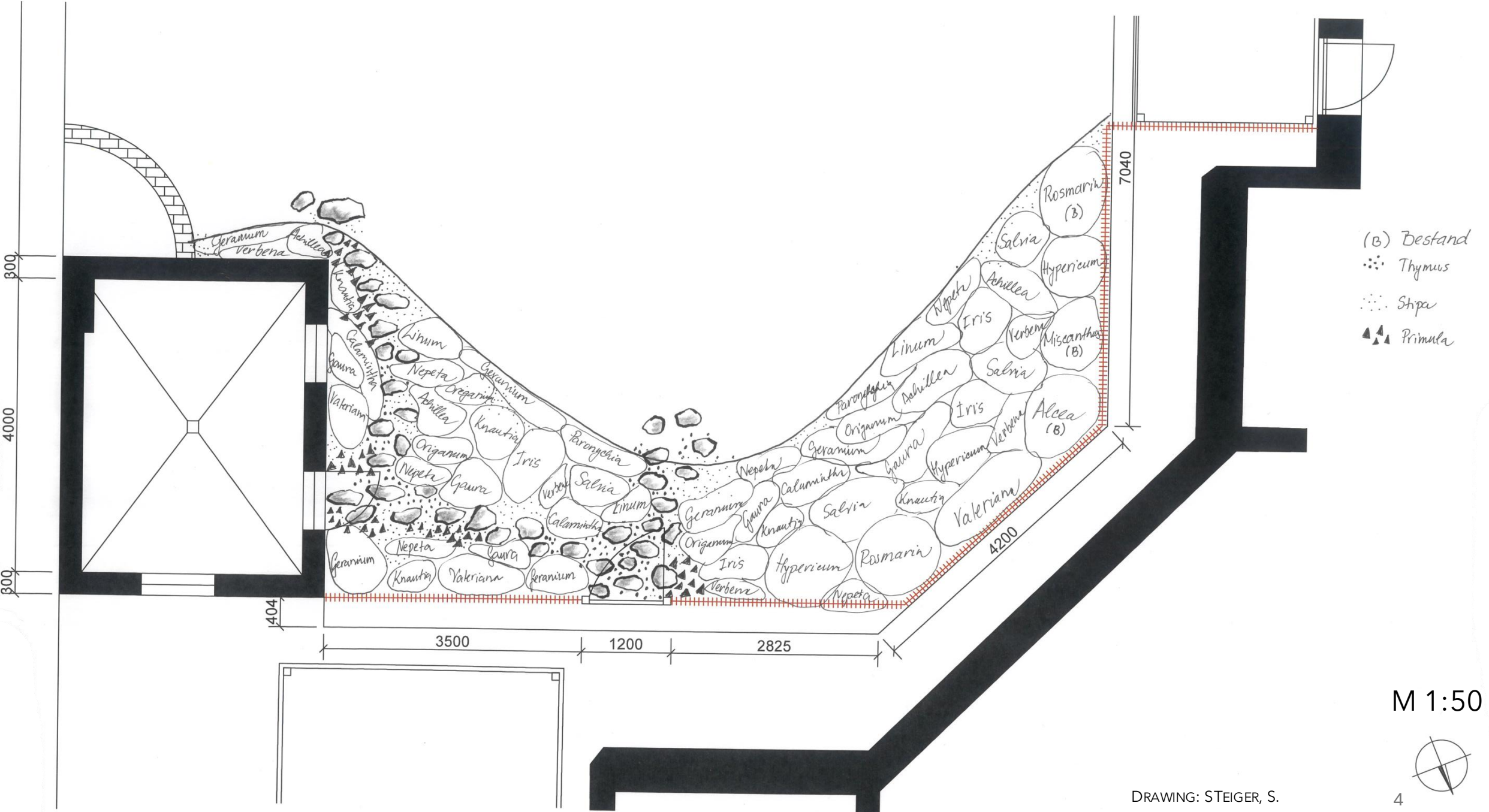

M 1:50



DRAWING: STEIGER, S.



11- *Knautia arvensis*
 4 - *Salvia rosmarinus*
 13- *Linum flavum* „compactum“
 7 - *Alcea rosea*



1 - *Calamintha nepeta*
 12- *Knautia macedonica*
 2 - *Hypericum perforatum*
 18- *Primula veris*



14- *Stipa tenuifolia*
 6 - *Achillea millefolium*
 19- *Salvia pratensis* „Lapis Lazuli“
 10- *Iris graminea*



5 - *Valeriana officinalis*
 9 - *Geranium sanguineum* „Apfelblüte“
 3 - *Miscanthus* ssp.
 16- *Origanum vulgare*



20- *Thymus serpyllum*
 21- *Verbena bonariensis*
 17- *Paronychia kapela* ssp. *serpyllifolia*
 26- *Nepeta racemosa* „Snowflake“



perennials/grasses	plant variety	height cm	I	II	III	IV	V	VI	VII	VIII	IX	X	XI	XII	Lebensbereich***	dynamic/static	sociability**	Galßmaier pcs/m2*	Hameter pcs/m2	Simona pcs
1	Calamintha nepeta sp. Nepeta	Triumphator 30-50													FR/FS/St1	static	I-II	9,4	8	11
2	Hypericum perforatum	30-70													FR1-2	static	II	7,2	6	14
3	Miscanthus ssp.	Bestand 100-130													FR/B2	static	I	0,7	1	1
4	Rosmarinus officinalis	Bestand 50-100													B1-2	static	I	4,6	4	6
5	Valeriana officinalis	100													FR3/GR2-3	static	I	3,2	2	7
6	Achillea millefolium	60													FR1-2	dynamic	I	9,4	6	18
7	Alcea rosea	Bestand 150-200													B2	dynamic	I	2,4	4	1
8	Gaura lindheimeri	60-100													FR/B1	dynamic	II	7,2	5	20
9	Geranium sanguineum	Apfelblüte 20-30													GR/FR/ST1	dynamic	II-III	12,8	12	33
10	Iris graminea	30-40													FR/St/FS/GR1-2	dynamic	I-II	9,4	/	20
11	Knautia arvensis	30-100													FR1-2/GR2	dynamic	II	4,6	6	5
12	Knautia macedonica	60-100													FR/GR1-2	dynamic	I	3,2	5	2
13	Linum flavum	compactum 20													FR/SH/St/FS1	dynamic	I-II	18,5	12	26
14	Stipa tenuifolia	30-50													FR/SH/St/FS1	dynamic	I-II	12,8	8	-
15	Nepeta racemosa	Snowflake 20-25													FR/ST1b	dynamic	II-III	12,8	8	26
16	Origanum vulgare	25-40													FR/SH/St/FS1	dynamic	II	12,8	10	18
17	Paronychia kapela sp. serpyllifolia	3													St/FS/SF/MK1-2	dynamic	II	28	12	27
18	Primula veris	10-20													FR/GR1-2	dynamic	II-III	18,5	12	-
19	Salvia pratensis	Lapis Lazuli 50-100													FR/SH1	dynamic	I-II	7,2	6	23
20	Thymus serpyllum	5-10													ST/M/FR/H1	dynamic	II-III	12,8	10	-
21	Verbena bonariensis	100-150													FR1	dynamic	II	9,4	6	13
Geophyten																				
22	Narzissus poeticus	40-60															II	60	60	
23	Allium sphaerocephalon	70-100													FR/B1-2		II	18,5	8	
24	Allium flavum	30-40													ST/FR1-2		II-III	461,9	25	
25	Allium senescens	Lisa Green 20-30													FR/ST/FS1-2		II	18,5	8	
Woody/Thicket																				
26	Fraxinus ornus	800-1000																		

*The calculated number of plants per square meter is based on planting in a triangular pattern. (Vgl. Galßmayer)

**I: individually or in small tufts, 1-3 plants (up to a maximum of 5)
 II: in small groups of about 3-10 plants
 III: in larger groups of 10-20 plants
 (Vgl. Galßmaier (Vgl. Hansen/Stahl))

*** G Shrubbery
 GR Shrub-Edge
 Fr Open space with wildflower character
 b bed-like open space
 B Bed
 SH Open space with steppe-heath character
 H Open space with heath character
 St Stone arrangement
 FS Rock-Steppe
 M Mat
 SF Stone joint
 MK Wall-Crown
 (Vgl. Hansen/Stahl)



ILLUSTRATION: MACH, L.

PLAN - **STATIC/DYNAMIC**

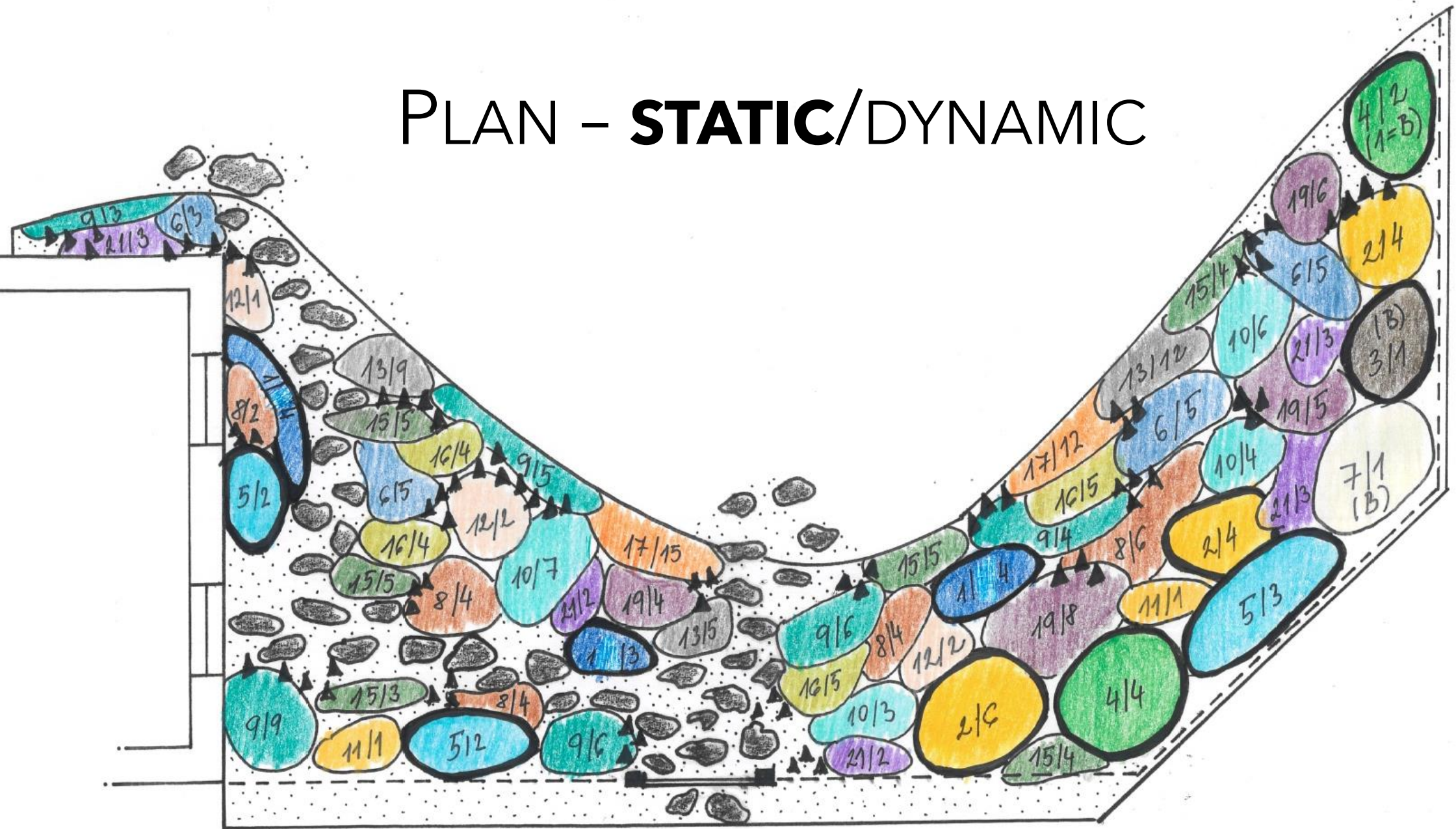

- (B) Bestand
- Matrix
- Geophyten

M 1:50



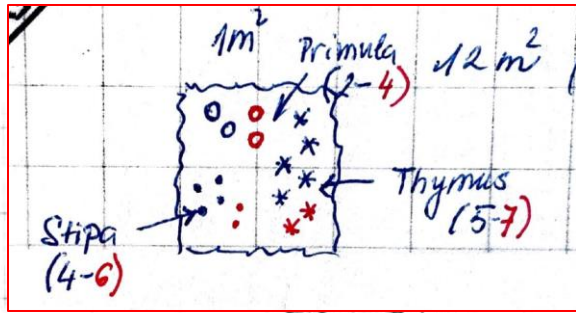

PLAN MATRIX

- Stepping Stones + Matrix: 13 m²
- (B) Bestand: 3 pcs
- 21 perennials 25 m²
- 38 m² + 1-2 m² grass
- 12 m² Matrix; 40-55 %
 (4,8-6,6m²) planted

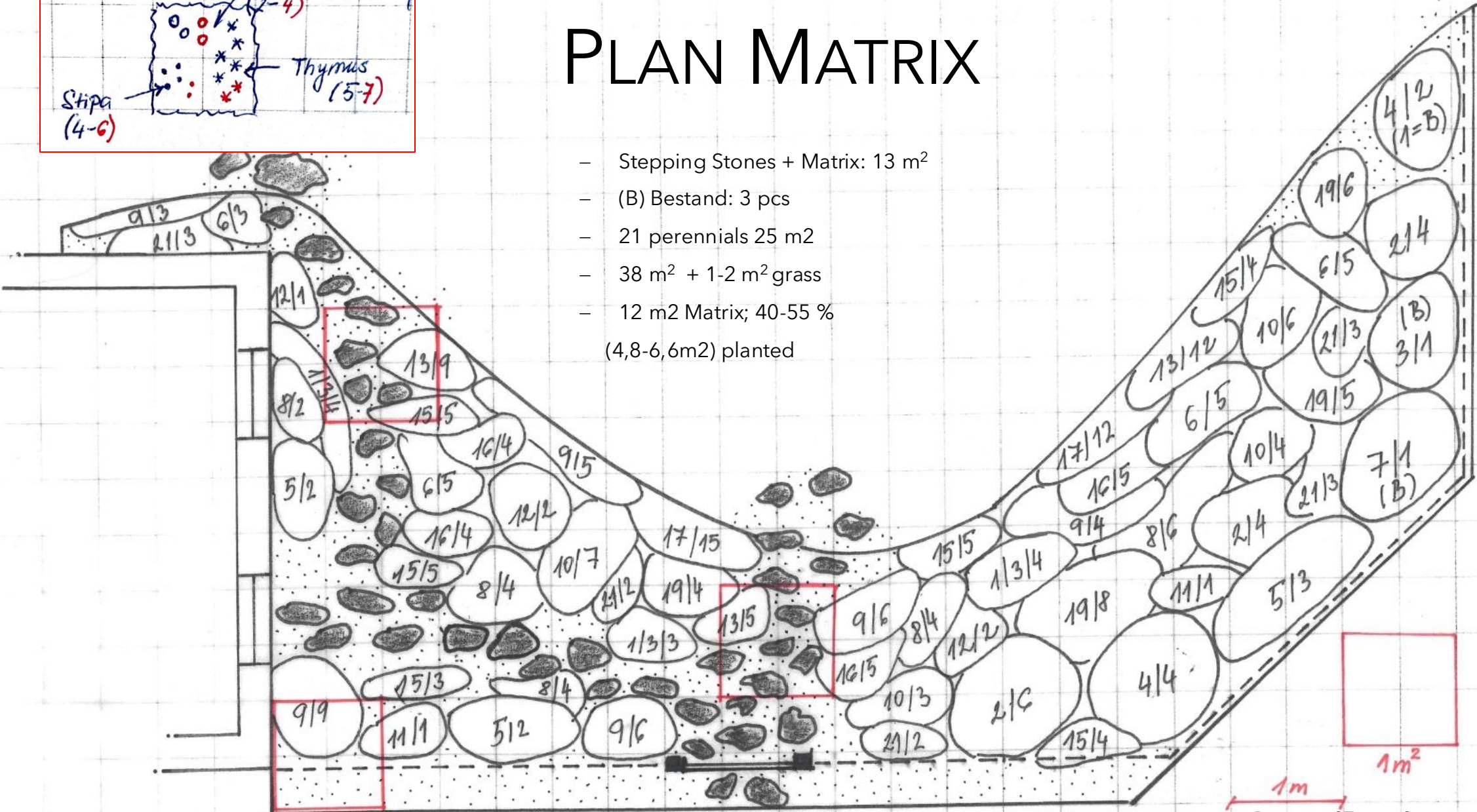

M 1:50



DRAWING: STEIGER, S.

PLANTING CONCEPT

Emergents/ Dominants Layer

e.g. *Alcea rosea*, *Rosmarinus officinalis*,
Valeriana officinalis, *Miscanthus ssp.*

Main canopy Layer = filler plants

e.g. *Achillea millefolium*,
Geranium sanguineum,
Iris graminea,
Knautia



Sub Canopy Layer

e.g. *Primula veris*
Achillea millefolium

Saisonal Layer

e.g. *Allium species*
Narcissus poeticus
Hypericum perforatum
Salvia pratensis lapis
lazuli

Ground Layer

e.g. *Paronychia kapela*

QUELLEN

- NICK ROBINSON; The Planting Design Handbook; 2016; third Edition; Routledge;
- THOMAS RAINER; West Claudia; Planting in a Post-Wild World; 2015; Timber Press; Portland, Oregon
- JAMES HITCHMOUGH; Sowing Beauty, Designing Flowering Meadows from Seed; 2017; Timber Press; Portland, Oregon
- NIGEL DUNNETT; Naturalistic Planting Design, The Essential Guide; 2019; Filbert Press;
- NORBERT KÜHN; Staudenverwendung; 2024, 2. Auflage; Eugen Ulmer KG; Stuttgart

