

plot overview



# OLHO DO SONHO

How do you dream?  
Can you hear sound?  
Do you see colours? Are you able  
to speak? Can you run away whenever  
you want to – or are invisible forces  
holding you back?

This art installation invites our minds to  
dive into our dreams – without any distractions.  
Walking through the four zones, we can slowly drift to the dark  
eye of the space. A place where our minds can wander to  
impossible places.



EYE OF THE DREAM

There are no words needed. You are invited to experience this  
space in quiet, without speaking. No voice, no noise – just dream.

**Zone IV** is the centerpiece, the eye of dream. A dark, soft and quiet  
space, that allows our minds to dream whilst being wide awake.

**Zone III** represents the bridge between the outer world and the  
centerpiece. It consists of a high pergola. Plants are winding up the  
round wooden structure and hanging down like a green curtain.

**Zone II** builds the first circle to enter when approaching the  
center. It has low vegetation that is exposed to the sun. It builds  
a low barrier to overcome before entering the piece of art.

**Zone I** is a flat and simple area of gravel and grass.  
The circular shape represents the shape of the object in the center.  
The area does not have a path and therefore invites to wander around.

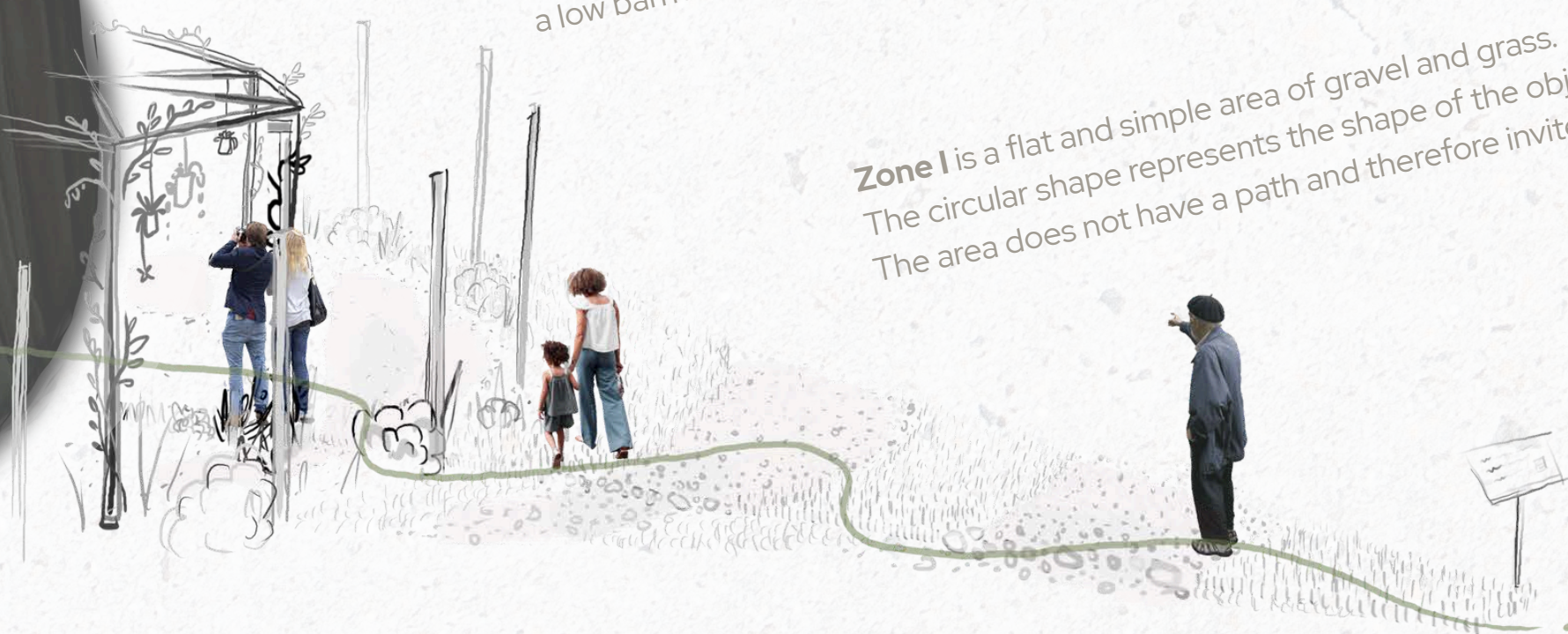

SCALE 1:200

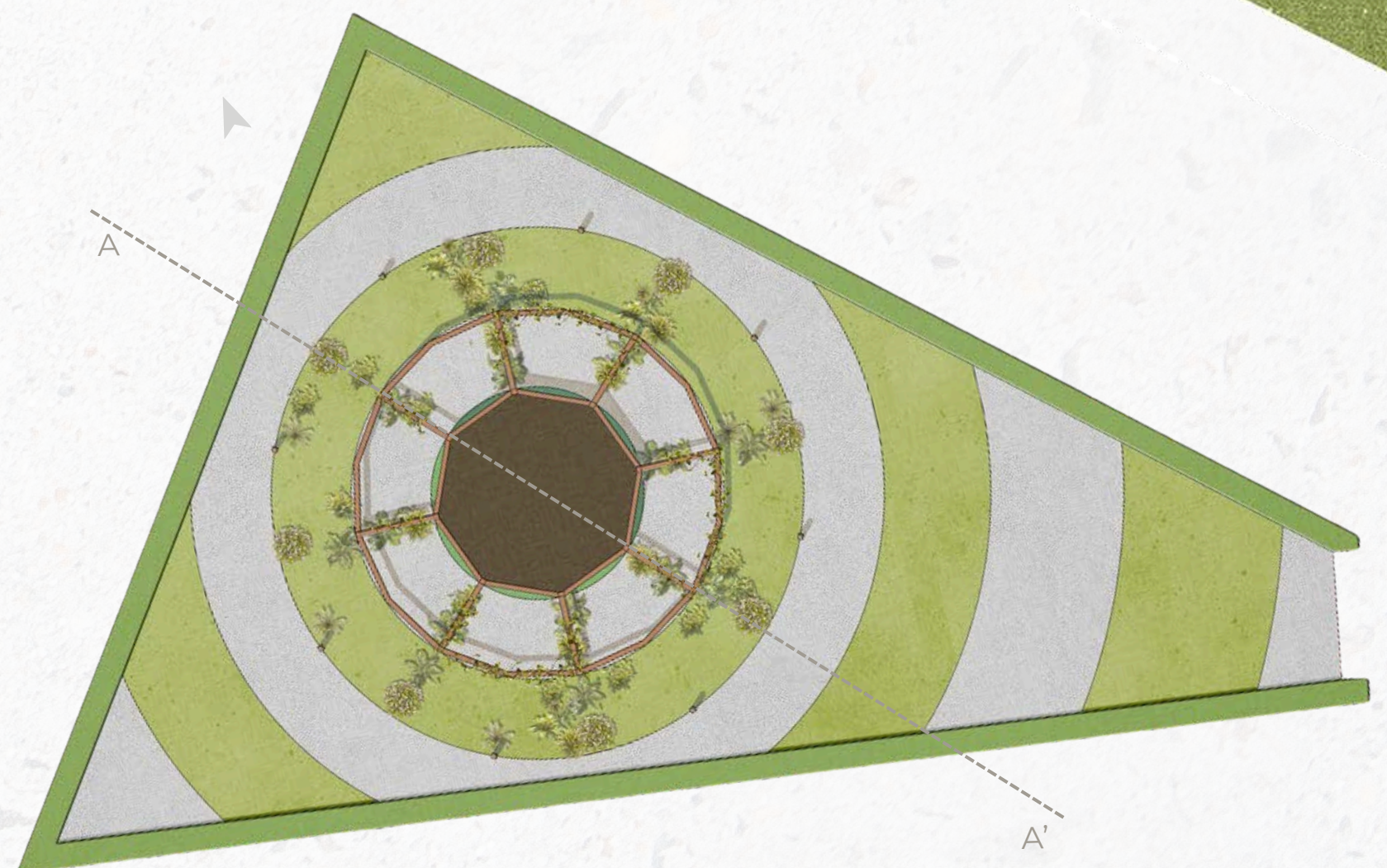

SCALE 1:200